

LOKACIJA ISPRED BANKE

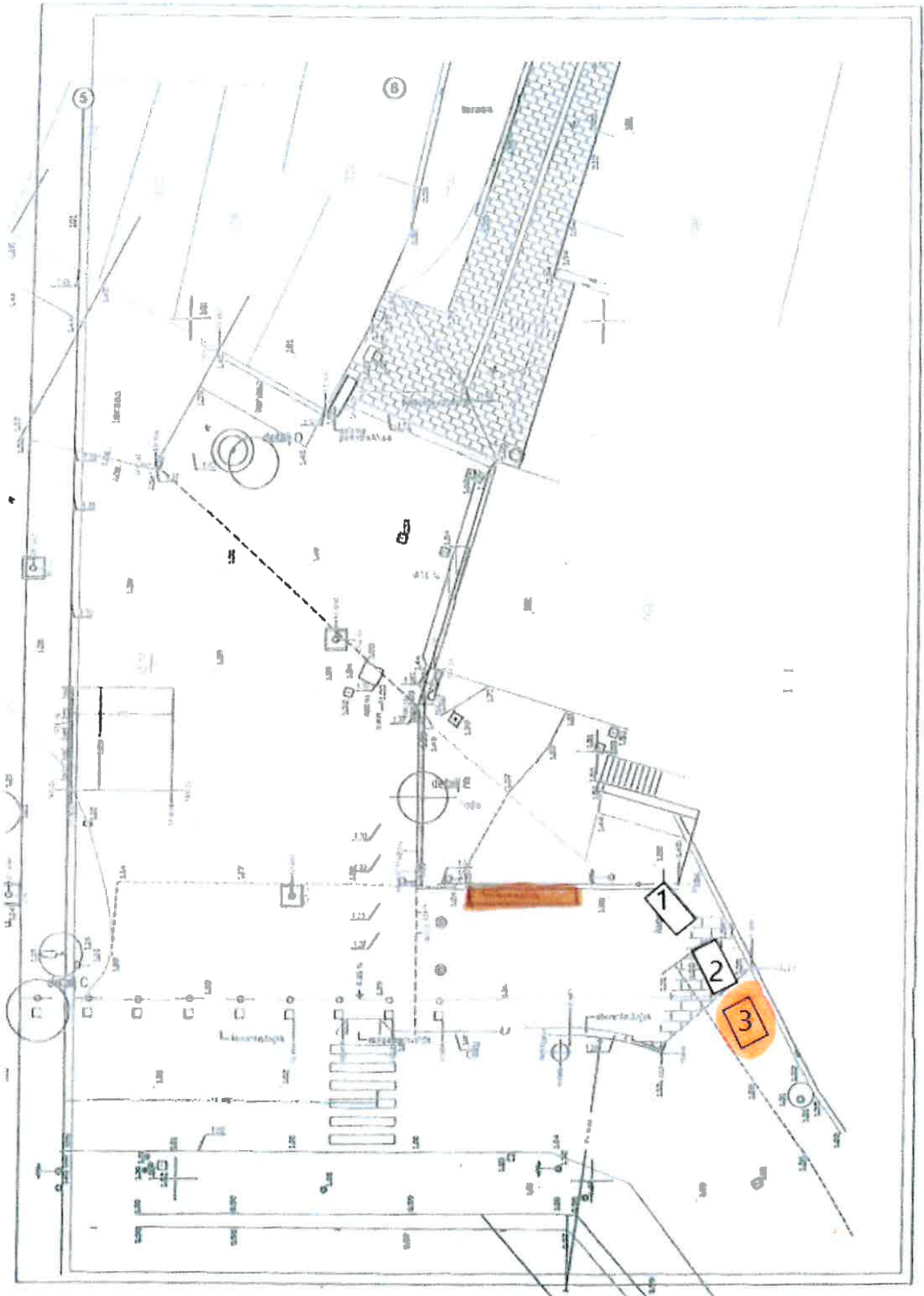

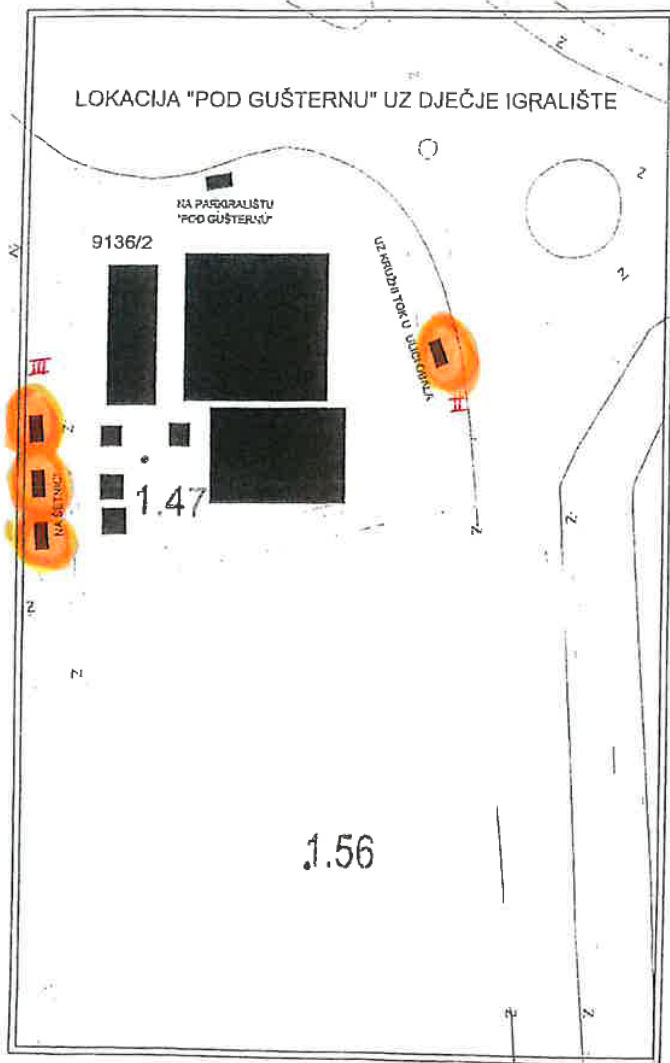

851

9136/2

1.47

1.56

LOKACIJA "POD GUŠTERNJU"
PLATO ISPOD AUTOBUSNOG STAJALIŠTA
UZ ULICU OBALA



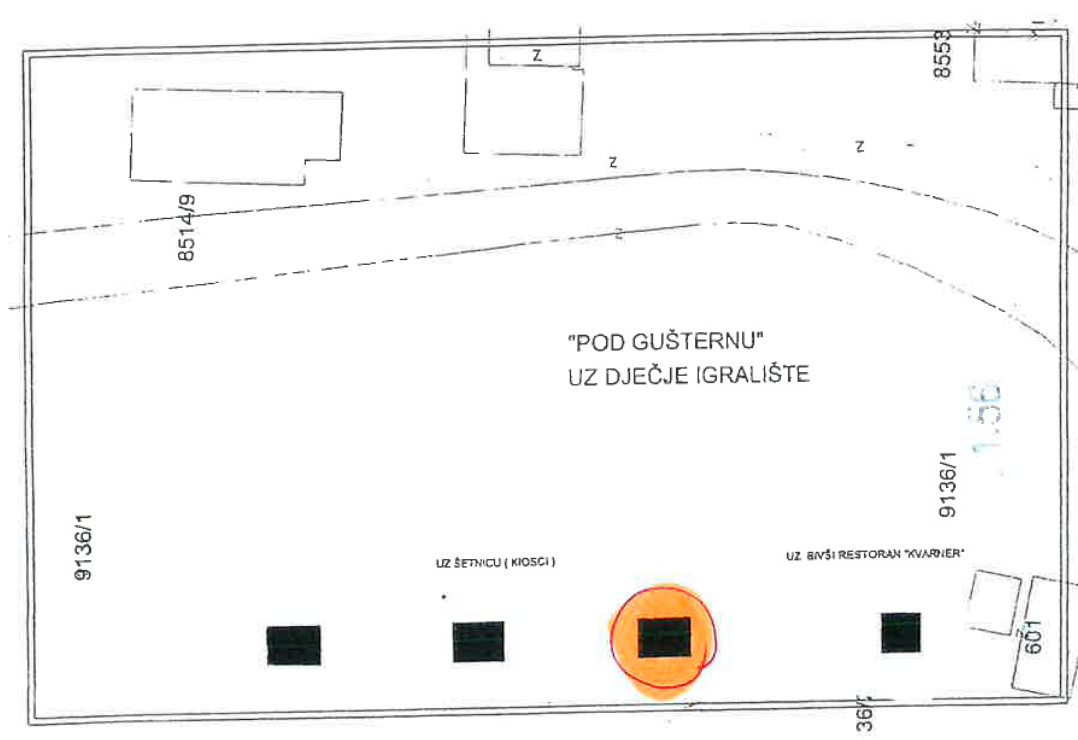

9136/1

8514/9

8558

"POD GUŠTERNU"
UZ DJEČJE IGRALIŠTE

UZ ŠETNICA (KIOSCI)

UZ BIVŠI RESTORAN "KVARNER"

9136/1

1.56

601

36/1

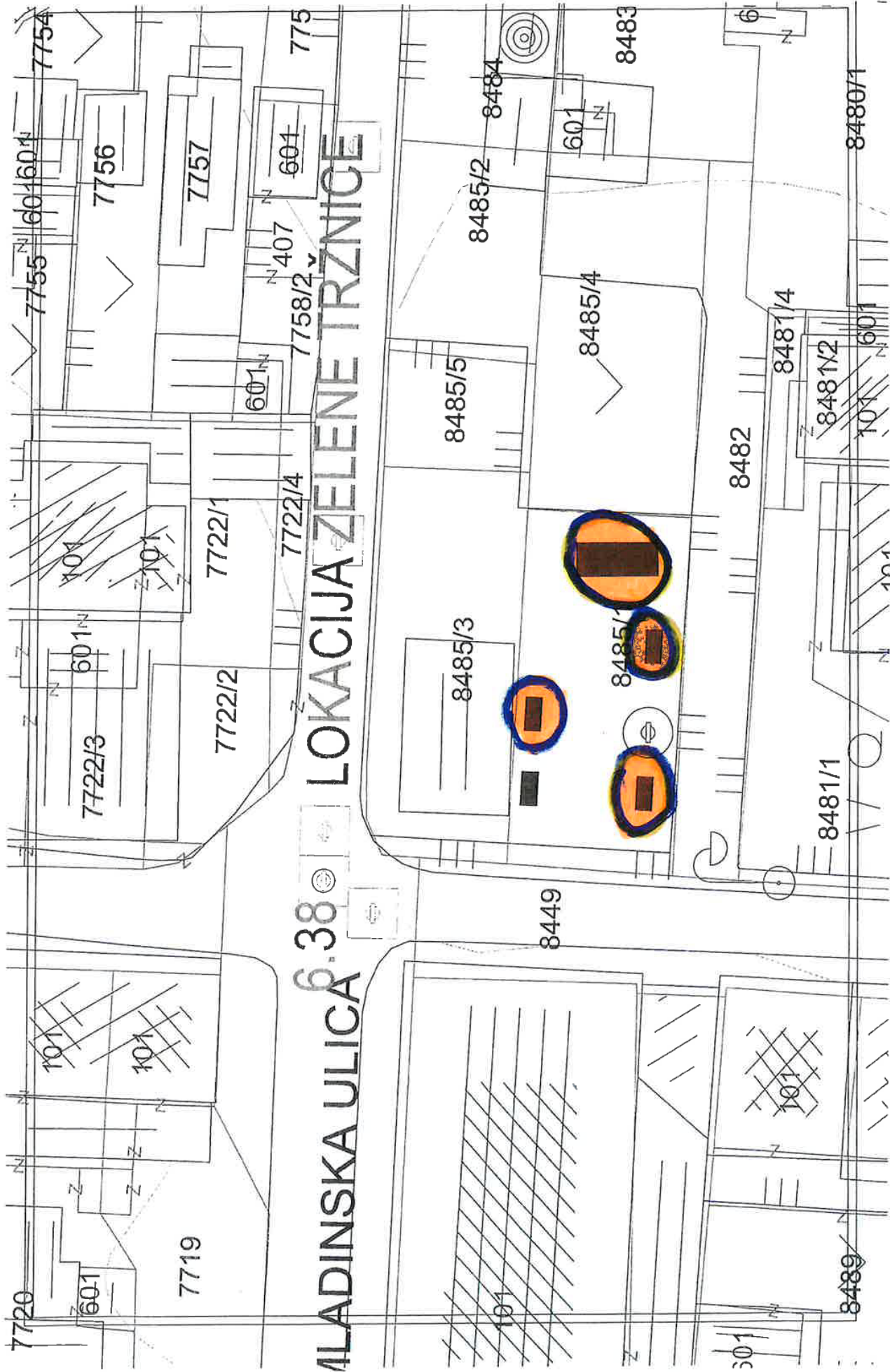

VLADINSKA ULICA 6.38 LOKACIJA ZELENE TRZNICE

16017 16018

16019

16020

16021

171

16022 16023

16024

16025

172

16026

16027

16028

16029

16030

16031

16032



16033 16034

16035

16036 16037

16038

16039

16040

16041 16042

16043

16044 16045

TERASA 16

Dana 01. lipnja 2018. godine u 12,30 sati izvršena je izmjera javne površine Terasa 16 na k.č.8514/12 k.o. Punat ispred objekta na adresi Obala 109.

OBJEKT	OBJEKT		
	<table border="1"><tr><td data-bbox="799 949 1221 1419">60 m² -</td><td data-bbox="1227 949 1435 1419">56,5 m²</td></tr></table>	60 m ² -	56,5 m ²
60 m ² -	56,5 m ²		

Ukupna površina: 116,5 m²

TERASA 19

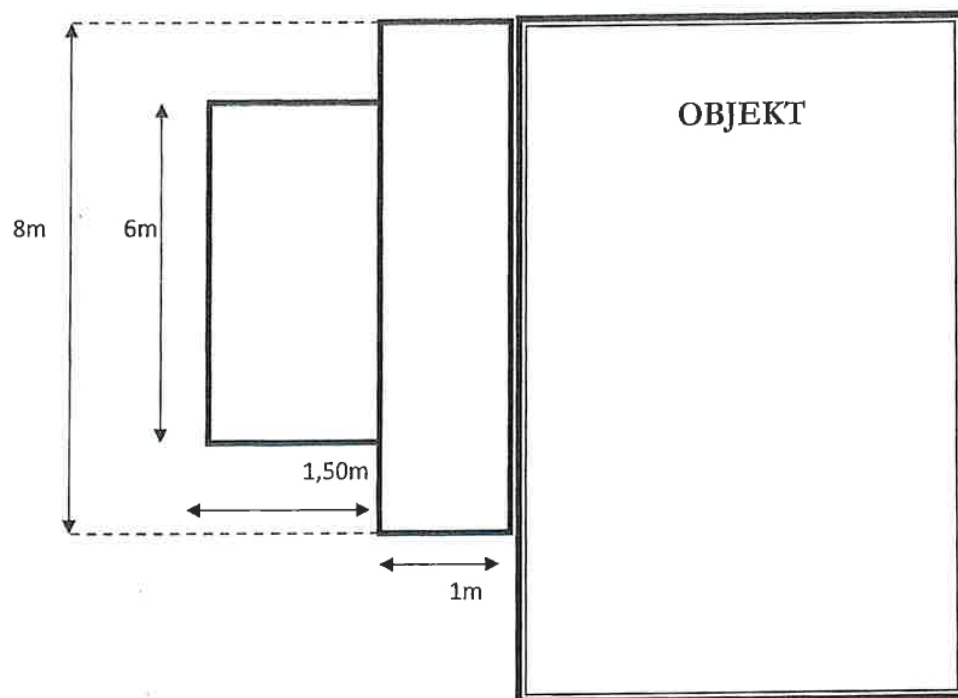

Ukupna površina: 17m²